

C. No. :- 1668 / 2006 / HRO / H1
CONFIRMED IN L.P. No. :- 493 / 2006 / HRO

REF. No. :- NIL - OF PS - INDRAKARAN GP (dt- 30-10-06)

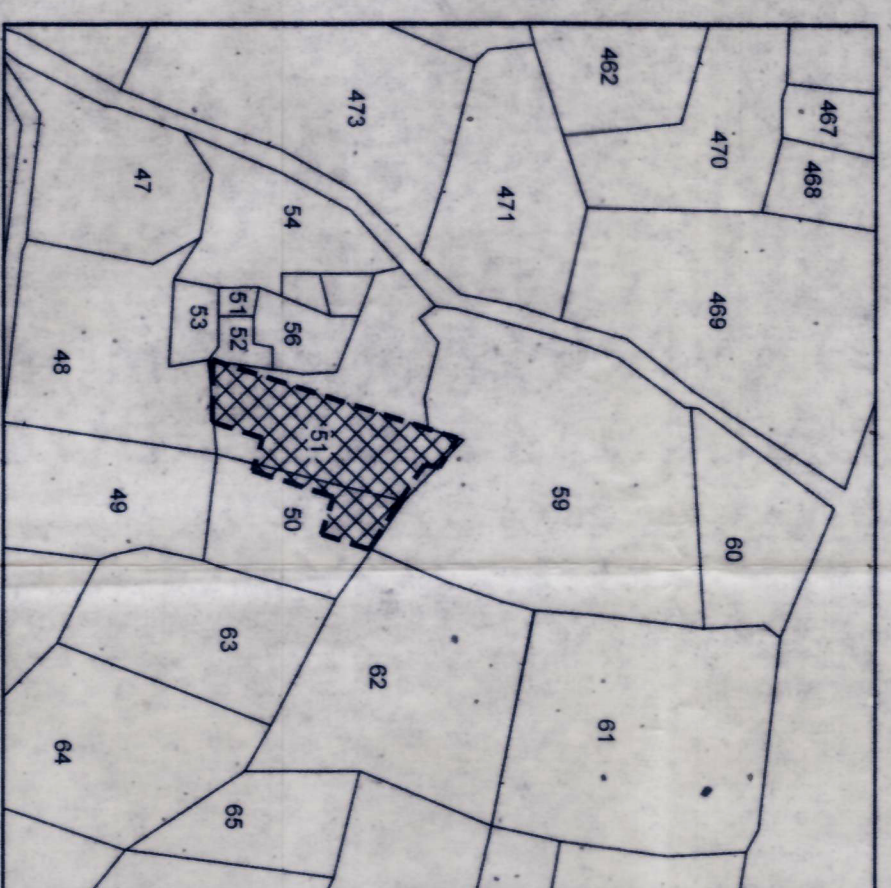



INDRAKARAN VILLAGE
EXTRACT OF VILLAGE MAP
SCALE :- 660' TO AN INCH
SITE UNDER REFERENCE

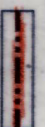

STATEMENT OF AREAS

TOTAL AREA	: Acs. 5.000
ROAD AREA	: Acs. 1.196 (23.92 %)
OPEN AREA	: Acs. 0.504 (10.08 %)
No. OF PLOTS	: 36 PLOTS

REFERENCE :

-  SITE BOUNDARY
-  EXISTING ROADS
-  PROPOSED ROADS
-  PUBLIC PLACE

INDRAKARAN GRAMPANCHAYATH

TECHNICAL LAYOUT PATTERN FOR
RESIDENTIAL PLOTS IN SURVEY
NUMBERS 50 PART & 51 PART OF
INDRAKARAN VILLAGE, SANGAREDDY
MANDAL, MEDAK DISTRICT.

SCALE :: 1" = 66'-0"

 ASSISTANT DIRECTOR
 TOWN AND COUNTRY
 PLANNING

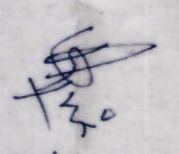
 REGIONAL DEPUTY DIRECTOR
 TOWN AND COUNTRY
 PLANNING HYDERABAD

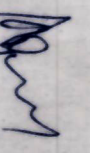
 ARCH. D' MAN / SURVEYOR

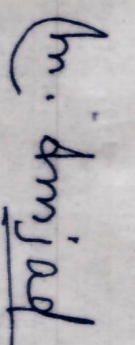
 TOWN PLANNING ASST.